

# WSA-100 Utility Station

## Quick Start Guide

P/N 5900095 — Rev. C — Jan. 2026

The WSA-100 Utility Station (SKU 5210627) easily adds air and electrical outlets to the following BendPak Lifts:

### Four Post Lifts:

- HD Series (HD-7/9/14)
- HDS Series (HDS-14/18/27/35/40)
- HDSO-14 Series
- D4-12 Model
- APEX 4-Post Lifts

### Two-Post Lifts:

- GP-7 Series
- 10AP Series
- XPR Series (XPR-9/10/12/15/18)
- D2 Series (D2-8/10/12/15)
- APEX 2-Post Lifts

This illustration shows the main components of the WSA-100 Utility Station.

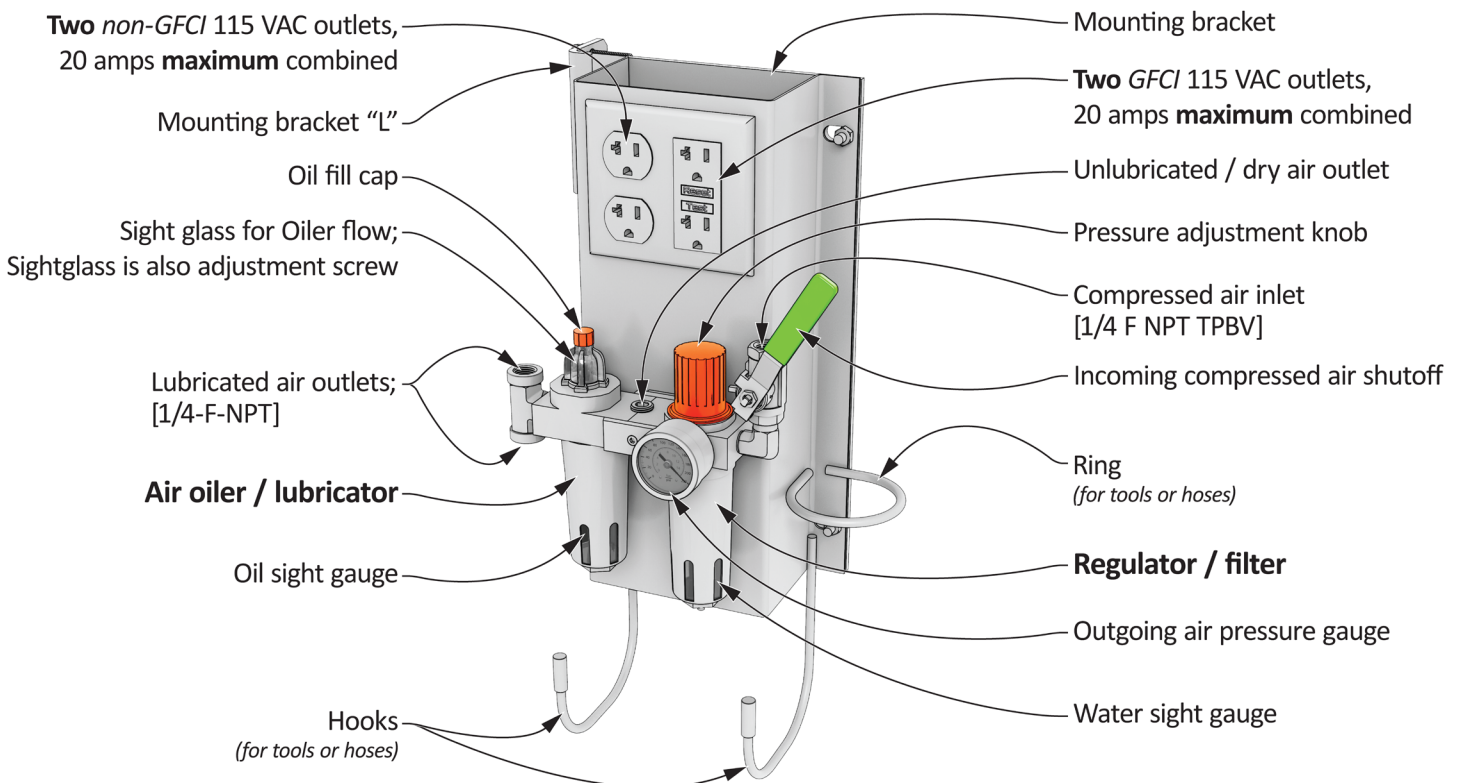

**⚠ WARNING California Proposition 65:** This product can expose you to chemicals including styrene and vinyl chloride, which are on the list of over 900 chemicals identified by the State of California to cause cancer, birth defects, or other reproductive harm. Always use this product in accordance with BendPak's instructions. For more information, visit [www.p65warnings.ca.gov](http://www.p65warnings.ca.gov).

**⚠ WARNING** If mounting on specific Lifts requires drilling into Power Side Post, it is *crucial* that the WSA-100 Utility Station is centered on the Lift Post when drilling the hole locations. **The hole locations are critical to avoid interference with the internal Post components.** If you do mount WSA-100 by drilling your own holes, ensure that any fasteners protruding into the Post cavity **do not** interfere with **any** Lift mechanisms – this is *critical* for continued safe operation of the Lift.

# BendPak®

30440 Agoura Road  
Agoura Hills, CA 91301 USA

The main components of the WSA-100 are:

- **Four 115 VAC outlets.** Two have GFCI, two do not. Maximum current 20 Amps. Have a licensed electrician connect outlets to 1 phase, 60 Hz, 115 VAC using suitable conduit (not supplied). Duplex receptacle must be connected through the GFCI with the input line to the box connected to a circuit breaker or time delay fuse rated at 20 amps. Both receptacles *must* be grounded to the box. Note that the maximum amperage for one outlet in use is 20 amps total; **when using all four outlets, the combined total cannot exceed 20 amps.**

**⚠ DANGER** All wiring *must* be performed by a licensed Electrician in accordance with local and national electrical codes.

- **One ring and two hooks.** For holding tools and hoses, for example. The large hooks ensure that the electrical cords can be stowed away neatly and out of the way.
- **Air source.** Brings pressurized air to your lift. There are three parts to the air source:
  - **Incoming air.** Connect an incoming air supply to the Air **In** connector. You need to supply an appropriate 1/4" NPT fitting for the Air **In** connector.
  - **Regulator / Filter.** Removes contaminants from incoming air. Includes a gauge that shows the pressure of the outgoing air. Non-lubricated air can be used to put air into tires or for tool calibration. To adjust air pressure, lift the Pressure Adjustment Knob to unlock and **turn clockwise to increase pressure** and **turn counterclockwise to decrease pressure.** Push Knob back down to lock in new pressure setting.
  - **Oiler / Lubricator.** Provides pneumatic oil, for tool lubrication, suspended in the incoming air. Pressurized air, saturated with oil, provides lubrication to pneumatic tools, which reduces friction and helps them last longer. Only use lubricated air with pneumatic products that require it.

#### To drain water from the Regulator/Filter Reservoir:

1. Check the Water Sight Gauge to see how much water is currently in the Reservoir.

**⚠ CAUTION** If the Reservoir is one quarter ( $\geq 25\%$ ) or more filled with water, *drain it.*

2. Shut the compressed air **Shutoff Valve**; disconnect the compressed air source at the Air **In** connector. Bleed downstream system pressure as needed.
3. Press upwards on the Water Drain Plug at the bottom of the Reservoir. Water will drain out.
4. Release the Water Drain Plug and re-connect the air source.

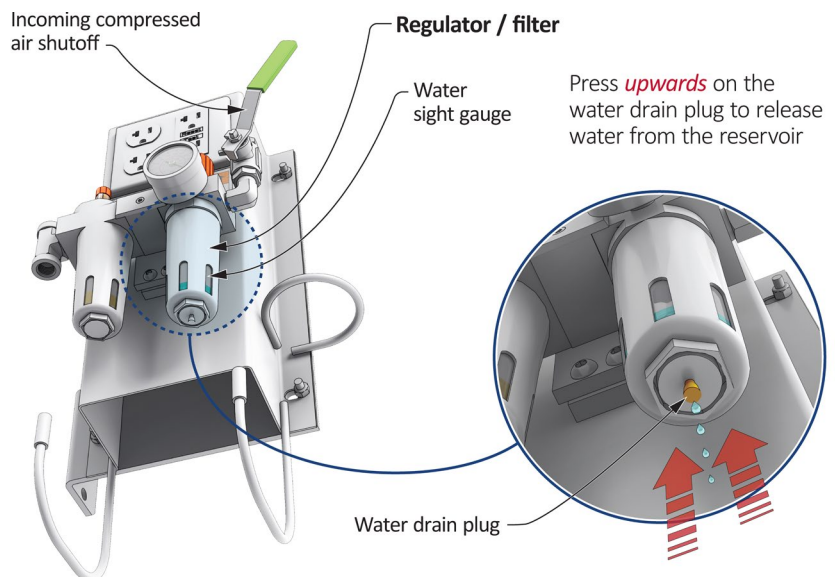

## To add pneumatic oil to the Oiler/Lubricator:

1. Check the Oil Sight Gauge to see how much pneumatic oil is currently in the reservoir.

**⚠ CAUTION** If the reservoir is less than one half ( $\leq 50\%$ ) filled with pneumatic oil, **add oil to it.**

2. Shut the compressed air **Shutoff Valve**; disconnect the compressed air source at the Air **In** connector. Bleed downstream system pressure as needed.
3. Turn the oil reservoir Oil Fill Cap counter-clockwise and remove.
4. Add SAE 10W Air Tool Oil or generic pneumatic oil to the reservoir.
5. Put the oil reservoir back in place, turning it clockwise until tight, then re-connect the air source.

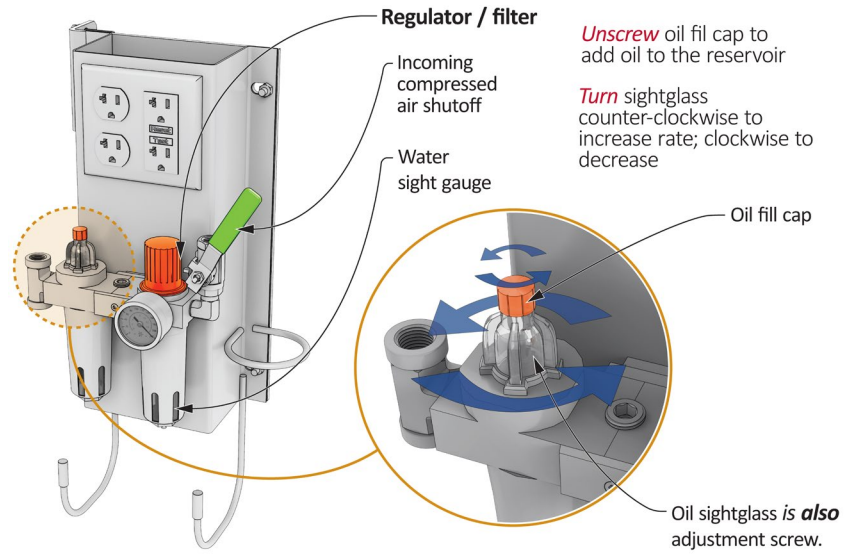

## To check the oil feed rate on the Oiler/Lubricator:

1. Use a device that uses lubricated air.
2. Watch the Sight Glass to see how much pneumatic oil comes out. Your goal is 1 or 2 drops per minute. The rate may vary slightly based on the tool manufacturer's recommendations.
3. If you are not getting 1 or 2 drops, turn the sightglass itself counterclockwise (the sightglass **is** the adjustment knob) to increase the rate or clockwise to decrease the rate. Use the device again to check the rate.

When you are getting 1 or 2 drops, **stop.**

## To attach the WSA-100 to a Lift Post:

- **Two-Post Lifts.** For *most* Two-Post Lifts, use the Power Unit mounting bracket on the Powerside Post when available. See illustration for details.

**⚠ WARNING** For Two-Post Lifts, it is crucial that the WSA-100 Utility Station is centered on the Lift Post when drilling the hole locations. **The hole locations are critical to avoid interference with the internal Post components.**

Illustrations A & B show how to connect the WSA-100 to BendPak **Two-Post Lifts**.

In example **A** the WSA-100 is connected to the Power Unit mounting, with the WSA-100 mounting bracket's Ls facing left. This is installed onto the Power Unit Mounting Bracket directly, along with the accessory bolted shim, and then the Power Unit vibration damper is installed, followed by the Power Unit, the split lock washers and the bolts, which thread into the rivet nuts in the Power Unit Mounting Bracket.

In example **B** the WSA-100 is connected *directly* to the Power Side Post Housing, immediately above the extensions storage area, with the WSA-100's mounting bracket completely removed. The WSA-100 is installed directly onto the Power Side Post Housing using the bolts and washers provided for that task.

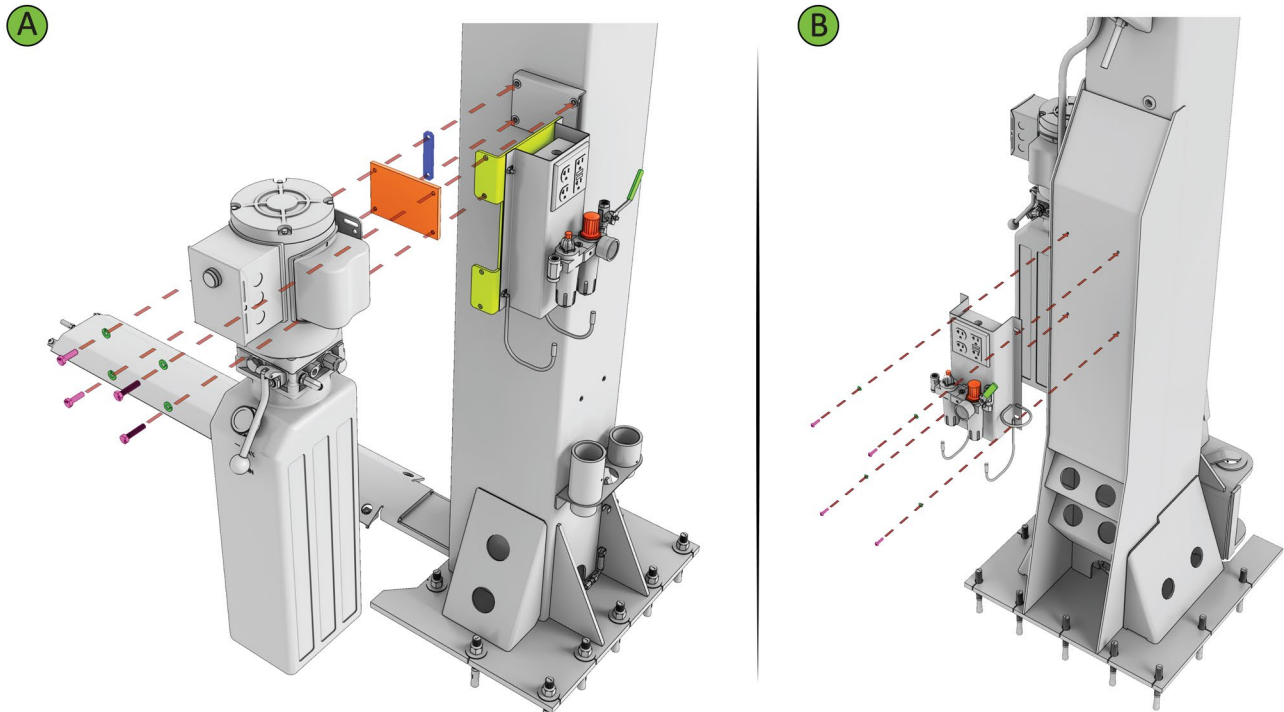

*If* you have an installation which *does not* correspond to one of the conditions illustrated, but requires instead that you use the bare side of the Power Post (opposite from where the Power Unit is mounted) and drill your own holes, then set the Mounting Bracket aside, and use the WSA-100 housing as a guide to mark the four (4) hole locations on the Lift Post; mark twice, then drill 11/32" diameter holes.

**⚠ WARNING** Verify that fastener ends, nuts or other hardware placed inside a Post **do not interfere at all** with internal Lift components which may travel along the post.

Secure the WSA-100 in place in a manner similar to example **B** - see the illustration for details.

**Four-Post Lifts.** For light and medium duty Four-Post Lifts (HD-7/9/14), use the unused mounting bracket on the Powerside Post when available. See illustrations for details.

Illustrations C & D show how to connect the WSA-100 to BendPak **Four-Post Lifts**.

In example **C** the WSA-100 is connected to the unused Power Unit mounting, with the WSA-100 mounting bracket's Ls facing left. This is installed onto the Power Unit Mounting Bracket directly, using the provided split lock washers and bolts, which thread into the rivet nuts in the Power Unit Mounting Bracket. Note that in this example illustration, the fit next to the Push Button Air Valve is tight, but not problematic; if your Push Button Air Valve interferes with where the right edge of the WSA-100 will be, the Push Button air Valve mounting hardware is ductile enough to reshape just enough to allow the WSA-100 installation.

In example **D** the WSA-100 is connected *directly* to the active Power Unit mounting, with the WSA-100 mounting bracket's Ls facing *right* (this means the mounting bracket was rotated 180°). The WSA mounting bracket is installed onto the Power Unit Mounting Bracket directly, along with the accessory bolted shim, and then the Power Unit vibration damper is installed, followed by the Flex Tube and Push button Air Valve mounting assemblies, *then* the Power Unit, the split Lock washers and the bolts, which thread into the rivet nuts in the Power Unit Mounting Bracket.

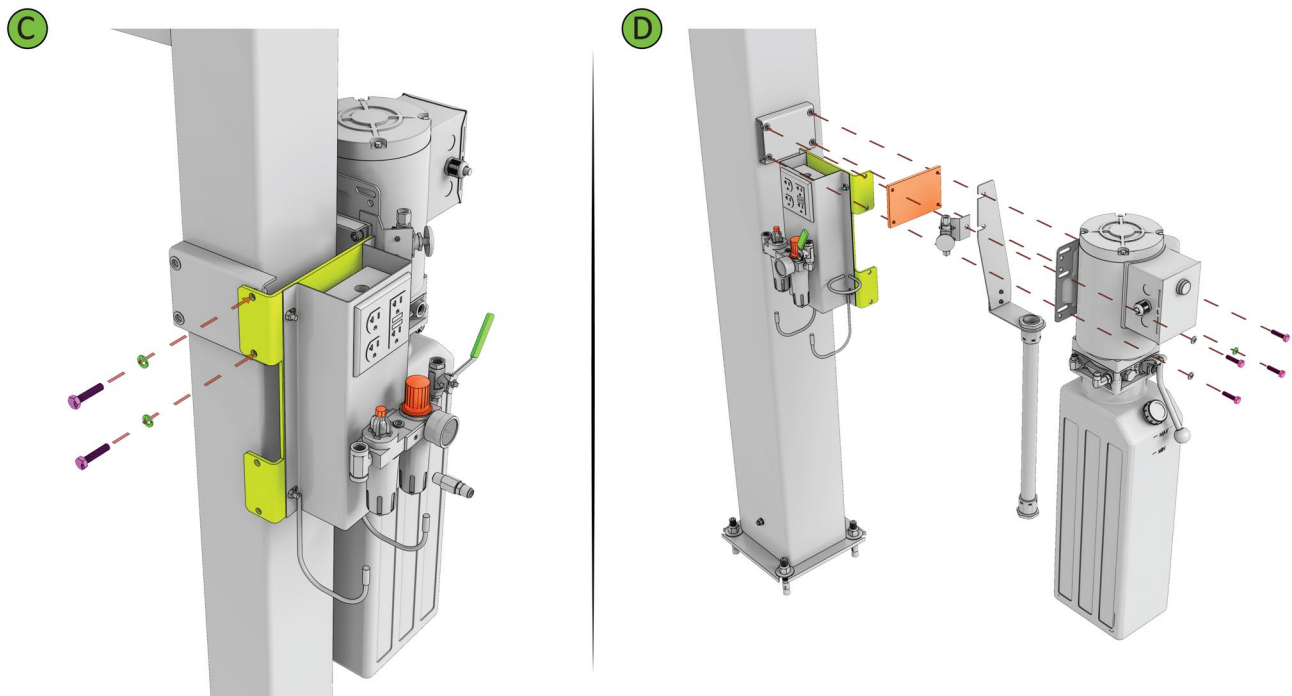

*If* you have an installation which *does not* correspond to one of the conditions illustrated, but requires instead that you use the bare side of the Power Post (opposite from where the Power Unit is mounted) and drill your own holes, then set the Mounting Bracket aside, and use the WSA-100 housing as a guide to mark the four (4) hole locations on the Lift Post; mark twice, then drill 11/32" diameter holes.

**⚠ WARNING** Verify that fastener ends, nuts or other hardware placed inside a Post *do not interfere at all* with internal Lift components which may travel along the post.

Secure the WSA-100 in place in a manner similar to example **B** - see the relevant illustration for details.

If you experience difficulties with these instructions, or your WSA-100, technical support and service is available on the Web at [bendpak.com/support](http://bendpak.com/support), by email at [support@bendpak.com](mailto:support@bendpak.com), or by phone at **(800) 253-2363**. Follow the prompts to reach service. Online chat is also available at [www.bendpak.com](http://www.bendpak.com)

The Parts List Drawing details all parts to be expected in your kit, and their uses.

**NOTE: UNLESS OTHERWISE SPECIFIED.**

1. REFER TO MODEL FOR ADDITIONAL INFORMATION
2. SEE COLORS & GRAPHICS FOR LABEL PLACEMENT
3. SEE SHIPPING INSTRUCTIONS FOR FINAL PACKAGING
4. ASSEMBLE ITEMS AS SHOWN

WHERE USED  
2 POST LIFTS  
4 POST LIFTS

ITEM NO.	PART NUMBER	DESCRIPTION	QTY
1	5600397	UTILITY AIR STATION WELDMENT	1
2	5328425	AIR FILTER/REGULATOR/LUBRICATOR, 1/4 BSPP	1
3	5530065	BHSC M6 x 1.0 x 20 FT, CL 10.9	6
4	5545005	WASHER M6 x 12 FLAT, CL 10.9	6
5	5535357	NUT M6 x 1.0 NL, CL10.9	6
6	5550408	FTG TEE -04 F NPT x -04 F NPT x -04 BSPT	1
7	5550403	FTG NPL -04 F NPT x -04 BSPT	1
8	5520495	110V, 20 AMP GH 4-PLUG OUTLET	1
9	5550402	FTG ELB -04 F NPT x -04 BSPT	1
10	5550045	FTG VLV -04 NPT x -04 F NPT TPBV	1
11	5737417	WSA-100 MOUNTING BRACKET	1
12	5737517	WSA-100 SHIM, MOUNTING BRACKET	1
13	5530011	HHB M8 x 1.25 x 35 FT, CL 10.9	4
14	5545202	WASHER M8 x Ø1.5 SL, CL10.9	4
15	5900095	WSA-100 QUICK START GUIDE	1
16	5550417	FTG NPL 1/4 INS x -04 NPT	1
17	5530550	1/4"-19 BSPT STEEL HEX SOCKET PLUG	1

DO NOT SCALE DRAWING

NAME: DATE: TM: 09/10/2025

DIMENSIONS ARE IN MM

CHECKED: THIRD ANGLE PROJECTION

TITLE: WSA-100 ASSEMBLY, VER B

SIZE DWG. NO.: 5210627

SCALE: 1:5 SHEET 1 OF 1

BP BendPak  
30440 AGOURA RD.  
AGOURA HILLS, CA 91301

THE INFORMATION CONTAINED HEREIN IS THE SOLE PROPERTY OF BENDPAK INC. ANY REPRODUCTION OR TRANSMISSION OF THIS INFORMATION WITHOUT THE WRITTEN PERMISSION OF BENDPAK INC. IS PROHIBITED.

NEXT ASSEMBLY  
LIFT ACCESSORY



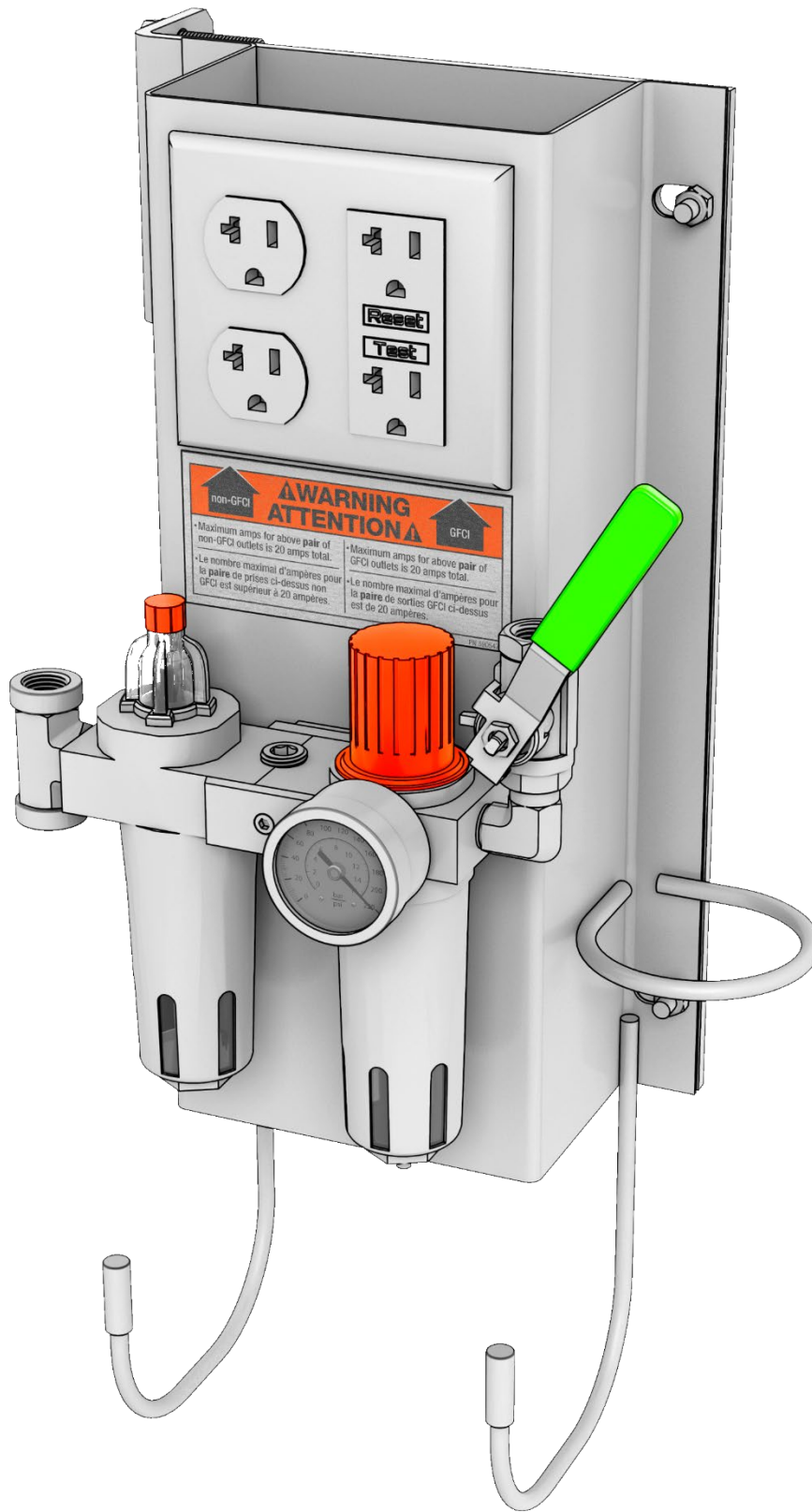

**BendPak**®

30440 Agoura Rd.  
Agoura Hills, CA 91301 USA

© 2026 by BendPak Inc. All rights reserved.

[bendpak.com](http://bendpak.com)